

RECORD OF SURVEY FOR JULIE SCHEAFER

BEING LOT 8 IN BLOCK 6 OF THE CITY OF SUTTER CREEK
ALSO BEING A PORTION OF THE NE 1/4 OF SECTION 7, T.6N.,
R.11E., M.D.M. CITY OF SUTTER CREEK, AMADOR COUNTY, CA.

SCALE: 1" = 20'

APRIL, 2003

DEED REF. 1993-11064

COUNTY SURVEYOR'S STATEMENT

THIS MAP HAS BEEN EXAMINED IN ACCORDANCE WITH SECTION 8766
OF THE LAND SURVEYORS ACT THIS NINTH DAY OF MAY
2003.

George E. Allen
GEORGE E. ALLEN L.S. 4951
LIC. EXP. 12-31-05

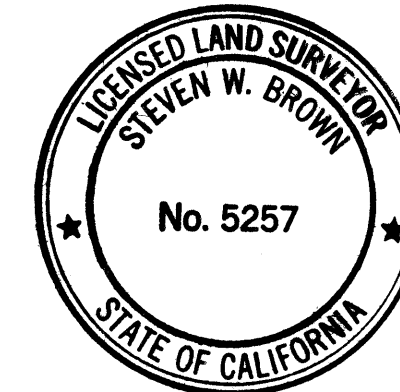

SURVEYOR'S STATEMENT

THIS MAP CORRECTLY REPRESENTS A SURVEY MADE BY ME OR UNDER
MY DIRECTION IN CONFORMANCE WITH THE REQUIREMENTS OF THE
LAND SURVEYORS ACT AT THE REQUEST OF JULIE SCHEAFER
IN APRIL, 2003

Steven W. Brown
STEVEN W. BROWN L.S. 5257
LIC. EXP. 12-31-03

RECORDER'S STATEMENT

FILED THIS 13th DAY OF May 2003 AT 1:18 P.M.
IN BOOK 55 OF MAPS AND PLATS AT PAGE 48 AT THE
REQUEST OF THE AMADOR COUNTY SURVEYOR. INST # 20030007193
FEE: \$75 pa. filed

Sheldon D. Johnson
SHELDON D. JOHNSON
AMADOR COUNTY RECORDER

Kimi Grady
DEPUTY

NOTES & LEGEND

- DENOTES 5/8" REBAR WITH PLASTIC CAP
STAMPED L.S. 5257 SET ON THIS SURVEY
 - TAGGED 3" STEEL FENCE CORNER POST
WITH BRASS TAG STAMPED L.S. 5257
 - FOUND 3/4" REBAR WITH PLASTIC CAP
STAMPED P.L.S. 3510 PER 52-M-71
 - FOUND 2" IRON PIPE TAGGED P.L.S. 3510
PER 52-M-71
 - () RECORD DATA PER 52-M-71
 - (()) RECORD DATA PER 14-M-44
 - [] FIELD NOTES OF SUTTER CREEK TOWNSITES
- THE BASIS OF BEARINGS AS SHOWN HEREON IS PER 52-M-71

SPANISH

STREET

SCALE: 1" = 20'

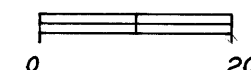

658-0.R.-214
SUTTER CREEK UNITED METHODIST CHURCH
LOT 7

CHISHOLM
LOT 8
1993-11064
BLOCK 6 - 0.14 ACRE

2.12' ACCESS EASEMENT PER 545-0.R.-649

GRADY
197009860
LOT 10

HENRY
525-0.R.-316

SLATER
2002016508

STEVEN W. BROWN- LAND SURVEYING

27 MAIN ST. JACKSON, CA. 95642 (209)223-1061

SCALE: 1" = 20'

APRIL, 2003

W.O. 3422