

# CORNER RECORD

Agency Index

BK 126 PG 72

Document Number

CR 13435

City of EDEN TOWNSHIP

County of ALAMEDA, California

Brief Legal Description MONUMENT LOCATED WITHIN SEVEN HILLS RD AT ALMOND ROAD

## CORNER TYPE

## COORDINATES (Optional)

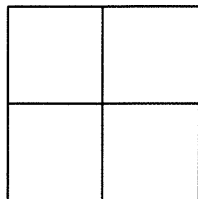

Government Corner ☐ Control ☒  
Meander ☐ Property ☐  
Rancho ☐ Other ☐

Date of Survey 8/20/19

N. E.

Elevation

Units Metric ☐ U.S. Survey Foot ☐

Horizontal Datum

Zone Epoch Date

Vertical Datum

☐ Complies with Public Resources Code §§8801-8819☐ Complies with Public Resources Code §§8890-8902PLS Act Ref: ☐ 8765(d) ☒ 8771 ☐ 8773 ☐ Other:

Corner/Monument: ☒ Left as found ☐ Established ☐ Rebuilt ☒ Pre-Construction  
☐ Found and tagged ☐ Reestablished ☒ Referenced ☐ Post-Construction

Narrative of corner identified and monument as found, set, reset, replaced, or removed:

☐ See sheet #2 for description(s):

FOUND 1-1/4" SQUARE BOLT.

MONUMENT FOUND 1' BELOW GRADE. EXCAVATED PRIOR TO REFERENCING.

FOUND AND SET POINTS AS SHOWN ON PAGE 2.

THIS POINT WAS REFERENCED PRIOR TO A CONSTRUCTION PROJECT IN THE VICINITY.

THE TIES SHOWN HEREON ARE FOR THE PURPOSE OF PERPETUATING FOUND MONUMENTATION.

NO CLAIM IS MADE AS TO THE RELATIONSHIP OF THE POINTS OR LINES SHOWN HEREON TO TRUE BOUNDARY LOCATION.

## SURVEYOR'S STATEMENT

This Corner Record was prepared by me or under my direction in conformance with

the Professional Land Surveyors' Act on AUGUST 26, 2019.

Signed SCOTT V. CUNHA P.L.S. or R.C.E. No. LS 8525

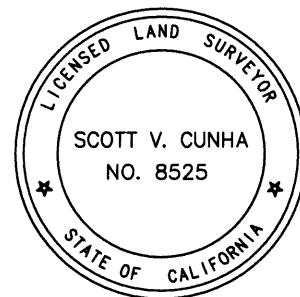

## COUNTY SURVEYOR'S STATEMENT

This Corner Record was received SEP 03 2019,

and examined and filed OCT 31 2019.

Signed D. Ian Wilson P.L.S. or R.C.E. No. 7010

Title ALAMEDA COUNTY SURVEYOR

County Surveyor's Comment



SPEC-2379-Pre

SCALE: 1"=30'

## LEGEND

- FOUND 1-1/4" SQUARE BOLT
- ⊗ SET CUT CROSS IN WALK
- SET REBAR & CAP STAMPED "CEI RP"
- 19592 REFERENCE STREET ADDRESS

