

ELECTRICAL LEGEND

DETAIL	DESCRIPTION
	SIMPLEX RECEPTACLE
	DUPLEX RECEPTACLE
	DUPLEX RECEPTACLE ABOVE COUNTER
	DUPLEX RECEPTACLE - GFCI
	DUPLEX RECEPTACLE - GFCI, ABOVE COUNTER
	SPLIT RECEPTACLE
	DUPLEX RECEPTACLE - WITH WEATHERPROOF COVER & GFCI
	DOUBLE DUPLEX RECEPTACLE
	DUPLEX RECEPTACLE IN CEILING
	DUPLEX RECEPTACLE - 20A, 125V, WITH ISOLATED GROUND
	BRANCH CIRCUIT HOME-RUN WITH CIRCUIT NUMBER
	FLOOR MOUNTED DUPLEX RECEPTACLE
	SPECIAL RECEPTACLE (SEE PLANS FOR TYPE)
	JUNCTION BOX
	MOTOR (SINGLE PHASE & THREE PHASE)
	TIME CLOCK
	VOLUME CONTROL
	PULL BOX - SIZE & TYPE AS REQUIRED
	TELEPHONE / DATA OUTLET
	TV CABLE OUTLET
	DISCONNECT - NON FUSED
	DISCONNECT - FUSED
	UTILITY METER
	ELECTRICAL PANEL

LIGHTING LEGEND

TAG	DESCRIPTION
	INTERIOR RECESSED DOWNLIGHT
	INTERIOR RECESSED DOWNLIGHT
	INTERIOR RECESSED DOWNLIGHT
	PENDANT
	PENDANT
	PENDANT
	TRACK LIGHT
	VANITY LIGHT
	WALL SCONCE
	2X4 LAY-IN TROFFER
	2X4 NIGHT LIGHT
	2X4 EMERGENCY LIGHT
	EXIT/EMERGENCY LIGHT W/ BATTERY PACK AND DUAL HEADS
	EXIT/EMERGENCY LIGHT WITH BATTERY PACK
	EXIT LIGHT (SURFACE MOUNTED)
	EXIT LIGHT (CEILING MOUNTED)
	REMOTE EMERGENCY HEADS
	EMERGENCY BATTERY PACK AND DUAL HEADS
	DIMMER SWITCH EQUAL TO LUTRON NOVA SERIES T
	TOGGLE SWITCH SINGLE POLE SWITCH WITH COVER PLATE
	TOGGLE SWITCH 2 POLE SWITCH WITH COVER PLATE
	TOGGLE SWITCH 3 WAY SWITCH WITH COVER PLATE
	TOGGLE SWITCH KEY OPERATED SWITCH WITH COVER PLATE
	PHOTOCELL
	WALL MOUNTED OCCUPANCY SENSOR
	CEILING MOUNTED OCCUPANCY SENSOR SENSORSWITCH MODEL #CMR 9 2P

GENERAL NOTES:

- A. ALL WORK TO COMPLY TO ALL STATE, LOCAL, NEC, & NFPA CODES.
- B. ELECTRICAL CONTRACTOR TO VISIT THE SITE PRIOR TO SUBMITTING A BID & INCLUDE IN THEIR BID ANY ITEM ANY ITEMS NECESSARY FOR A COMPLETE & OPERATIONAL SYSTEM.
- C. DRAWINGS ARE SCHEMATIC IN NATURE. ELECTRICAL CONTRACTOR IS TO ADD ANY ITEMS THAT ARE REQUIRED FOR A COMPLETE & OPERATIONAL SYSTEM IN THEIR PROPOSAL.
- D. ELECTRICAL CONTRACTOR IS TO COORDINATE THEIR INSTALLATION WITH THE OTHER TRADES, IF A CONFLICT OCCURS AND IT IS DUE TO THE ELECTRICAL CONTRACTOR'S LACK OF COORDINATION, ALL WORK INVOLVED IN RESOLVING THE CONFLICT WILL BE AT THE EXPENSE OF THE ELECTRICAL CONTRACTOR.
- E. ELECTRICAL CONTRACTOR SHALL PAY ALL FEES AND PERMITS.

ABBREVIATIONS

(A)	EXISTING TO BE ABANDONED	INCD	INCANDESCENT
(D)	EXISTING TO BE DEMOLISHED	KVA	KILOVOLT AMPERE
(E)	EXISTING TO REMAIN	KW	KILOWATT
(F)	FUTURE	LTG	LIGHTING OR LIGHT
(R)	EXISTING TO BE RELOCATED	LRA	LOCKED ROTOR AMPS
A	AMPERE	MCA	MAXIMUM CURRENT AMPACITY
AC	ALTERNATING CURRENT OR AIR CONDITIONER	MCB	MAIN CIRCUIT BREAKER
AFF	ABOVE FINISHED FLOOR	MCC	MOTOR CONTROL CENTER
AFG	ABOVE FINISHED GRADE	MDP	MAIN DISTRIBUTION PANEL
AIC	AMPS INTERRUPTING CAPACITY	MLO	MAIN LUGS ONLY
ANNC	ANNUNCIATOR	MOCP	MAXIMUM OVERCURRENT PROTECTION
AWG	AMERICAN WIRE GAUGE	MSB	MAIN SWITCHBOARD
BPS	BOLTED PRESSURE SWITCH	MH	METAL HALIDE
C	CONDUIT	MTS	MANUAL TRANSFER SWITCH
CB	CIRCUIT BREAKER	NAC	NOTIFICATION APPLIANCE CIRCUIT
CCTV	CLOSED CIRCUIT TELEVISION	NC	NORMALLY CLOSED
CKT	CIRCUIT	NO	NORMALLY OPEN
CM	CONSTRUCTION MANAGER	NF	NON-FUSED
DC	DIRECT CURRENT	OCC	OCCUPANCY
DP	DISTRIBUTION PANELBOARD	PA	PUBLIC ADDRESS
DTT	DOUBLE TWIN TUBE	PB	PULL BOX OR PUSH BUTTON
EB	ELECTRONIC BALLAST	PVC	POLYVINYL CHLORIDE (PLASTIC PIPE)
EC	ELECTRICAL CONTRACTOR	PWR	POWER
EM	EMERGENCY	RECPT	RECEPTACLE
EMT	ELECTRICAL METAL TUBING	STP	SHIELDED, TWISTED PAIR
EWC	ELECTRIC WATER COOLER	TC	TIME CLOCK
FA	FIRE ALARM	TRT	TRIPLE TUBE
FLA	FULL LOAD AMPS	TYP	TYPICAL
G	GROUND	UNO	UNLESS NOTED OTHERWISE
GC	GENERAL TRADES CONTRACTOR	UTP	UNSHIELDED, TWISTED PAIR
GFCI	GROUND FAULT CIRCUIT INTERRUPTER	V	VOLT
GEN	GENERATOR	W	WATT
HOA	HAND-OFF-AUTOMATIC	WAP	WIRELESS ACCESS POINT
HP	HORSEPOWER	WH	WATHOUR
HPC	HIGH PRESSURE CONTACT SWITCH	WP	WEATHERPROOF, NEMA 3R UNO
HZ	HERTZ	XFMR	TRANSFORMER
IG	ISOLATED GROUND	Z	IMPEDANCE
IMC	INTERMEDIATE METAL CONDUIT	Φ	PHASE

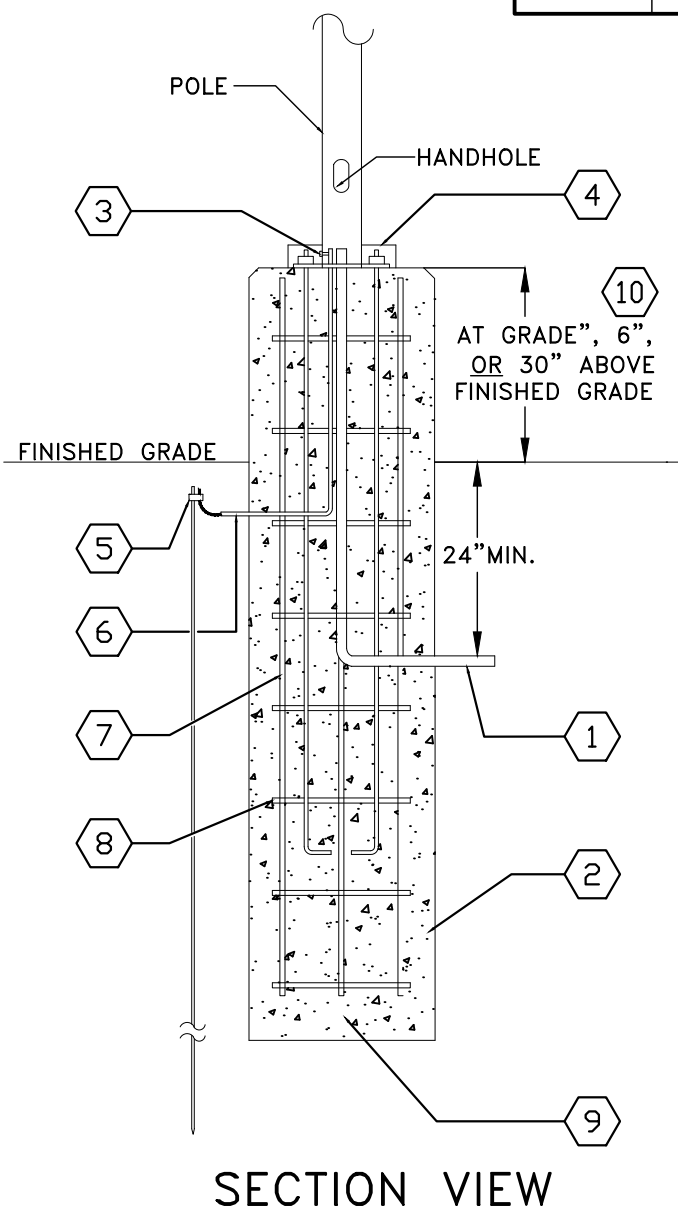

NOTES:

1. 1" OR AS NOTED (INSTALL ON MIN. 6" SAND BED WITH MIN. 6" SAND COVER BEFORE BACKFILL. CONDUIT SHALL BE FULL WEIGHT SCHEDULE 40 PVC).
2. REFER TO STRUCTURAL DRAWINGS.
3. PROVIDE GROUND LUG IN BASE BOLTED TO BASE PLATE. GROUND SHALL BE MIN. #10 SOLID. REFER TO STRUCTURAL DRAWINGS.
4. REFER TO STRUCTURAL DRAWINGS.
5. 1/2" EMT OR PVC FOR GROUND WIRE.
6. 1/2" EMT OR PVC FOR GROUND WIRE.
7. REFER TO STRUCTURAL DRAWINGS.
8. REFER TO STRUCTURAL DRAWINGS.
9. REFER TO STRUCTURAL DRAWINGS.
10. REFER TO STRUCTURAL DRAWING.
11. 24" MINIMUM RADIUS EXTENDED 3/4" MAXIMUM ABOVE FOUNDATION; NUMBER OF CONDUITS PER PLAN, 1" MINIMUM, OR AS NOTED.
12. CONDUIT STUB OUT FOR GROUND WIRE CONNECTION.

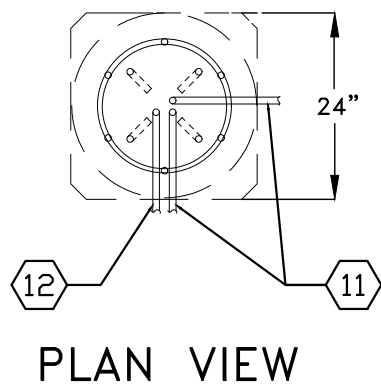

1 LIGHT POLE BASE DETAIL

N.T.S.

DRAWING INDEX

E0.0	GENERAL INFORMATION - ELECTRICAL
E1.0	SITE LIGHTING ELECTRICAL PLAN
E1.1	LIGHTING PLAN - ELECTRICAL
E2.1	POWER PLAN - ELECTRICAL
E2.2	POS SYSTEMS PLAN
E3.1	ROOF PLAN - ELECTRICAL
E4.1	DIAGRAMS AND DETAILS - ELECTRICAL
E5.1	SCHEDULES - ELECTRICAL
E7.1	SPECIFICATIONS - ELECTRICAL
E7.2	SPECIFICATIONS - ELECTRICAL
E7.3	SPECIFICATIONS - ELECTRICAL



PROPRIETARY INFORMATION NOTICE:
THESE PROTOTYPICAL DOCUMENTS MAY REQUIRE REVISIONS TO CONFORM TO LOCAL, STATE, AND FEDERAL CODES, ORDINANCES OR OTHER CONDITIONS. THE DESIGN CONCEPTS EMBODIED IN THESE DOCUMENTS ARE SPECIFICALLY FOR THIS PROJECT. INFORMATION CONTAINED HEREIN REMAINS THE SOLE PROPERTY OF ARBY'S RESTAURANT GROUP, IS CONFIDENTIAL AND PROPRIETARY AND IS NOT TO BE COPIED, REPRODUCED, DISCLOSED OR OTHERWISE TRANSFERRED TO OTHER PARTIES IN ANY FORM WHATSOEVER WITHOUT THE EXPRESS WRITTEN CONSENT OF ARBY'S RESTAURANT GROUP.



Copyright 2020 by Arby's Restaurant Group

ARBY'S RESTAURANT GROUP
INSPIRE DUAL REGULAR 40 - STANDARD
1632 AR-25 BYPASS
HEBER SPRINGS, AR 72543
FOR
RB AMERICAN GROUP, LLC
6200 OAK TREE BLVD., SUITE 250, INDEPENDENCE, OHIO 44131

PROJECT NUMBER:

ISSUE	DATE
PRELIMINARY	
PERMIT	
BID	
REVISION	

GENERAL INFORMATION
ELECTRICAL

SHEET:

E0.0