

CORNER RECORD

Agency Index BK 127 PG ~~61~~ 61
Document Number CR 13074

City of Berkeley (APN 61-2582-22-1) County of Alameda, California
Brief Legal Description Monument in Santa Barbara Road, near 767 Santa Barbara Road.

CORNER TYPE

COORDINATES (Optional)

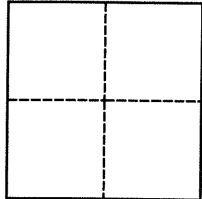

Government Corner ☐ Control ☒
Meander ☐ Property ☐
Rancho ☐ Other ☐

Date of Survey April 22, 2019

N. _____ E. _____

Elevation _____

Units Metric ☐ U.S. Survey Foot ☐

Horizontal Datum _____

Zone _____ Epoch Date _____

Vertical Datum _____

☐ Complies with Public Resources Code §§8801-8819

☐ Complies with Public Resources Code §§8890-8902

PLS Act Ref.: ☐ 8765(d) ☒ 8771 ☐ 8773 ☐ Other:
Corner/
Monument: ☒ Left as found ☐ Established ☐ Rebuilt ☒ Pre-Construction
☐ Found and tagged ☐ Reestablished ☒ Referenced ☐ Post-Construction

Narrative of corner identified and monument as found, set, reset, replaced, or removed:

☒ See sheet #2 for description(s):

Found monument near 767 Santa Barbara Road that could be damaged or destroyed by planned water line construction project. Monument was referenced as shown on page 2. The purpose of this Corner Record is to preserve possible evidence only; no attempt was made to determine the relationship to property, centerline, or right of way lines.

Reference EBMUD Field Book A, Page 31 (Clarke/Bergquist)

SURVEYOR'S STATEMENT

This Corner Record was prepared by me or under my direction in conformance with

the Professional Land Surveyors' Act on October 24, 2019

Signed [Signature] P.L.S. or R.G.E. No. 8889



COUNTY SURVEYOR'S STATEMENT

This Corner Record was received May 15, 2019

and examined and filed NOV 08 2019

Signed D. Ian Wilson P.L.S. or R.G.E. No. 7010

Title ALAMEDA COUNTY SURVEYOR

County Surveyor's Comment

ALAMEDA COUNTY SURVEYOR

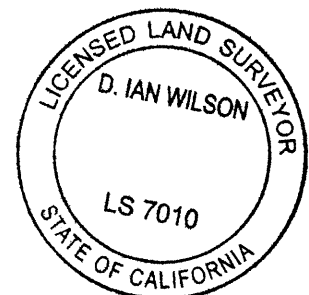

BERKELEY

ARLINGTON
HEIGHTS
26 M 26
BLOCK 2
8

ALAMEDA COUNTY

SANTA
BARBARA
ROAD
(50')

MONTROSE
ROAD
(50')

12.5' WEST OF
JOINT POLE
[97.88']

28.93'

[92.31']
17.5' SOUTH OF
WATER METER TO
HOUSE #44

69.80'

RN47HI
[100.00']

36.16'

[104.39']
1.5' OFF CTR
DRAIN INLET

[103.05']
5.5' OFF CTR
DRAIN INLET

38

767
SANTA BARBARA
ROAD
APN 61-2582-22-1

ARLINGTON
HEIGHTS
26 M 26
BLOCK 1
27

LEGEND



FOUND 2" BRASS DISK WITH PUNCH, STAMPED "CITY OF BERKELEY UNLAWFUL TO DEFACE" (CITY OF BERKELEY: B1550), DOWN 0.6' IN STANDARD MONUMENT WELL..



SET CONCRETE ANCHOR NAIL WITH PUNCH AND 1-1/2" ALUMINUM WASHER, STAMPED "EBMUD MON RP" IN TOP OF CURB.

AA##A#

ALAMEDA COUNTY MONUMENT DESIGNATION.

[100.00'] ASSUMED ELEVATION (MEASURED USING A LEICA DNA10 DIGITAL LEVEL).

ADDRESS: 767 SANTA BARBARA ROAD

APN: 61-2582-22-1



SCALE
1"=20'